

CAM OPERATED SWITCH



Series Y5

- Rotary CAM switch with lockable yale key
- Three different code for yale key
- The extraction of the key can be blocked in different position
- Body in nickel plated brass and other parts in plastic PA6
- Rate degree of protection: IP66
- Cable cross section: 1.5 ÷ 2.5 mm²
- Rated insulation voltage: 750V
- Max voltage: 660V
- Max rated operational current: 25A
- AC3 max current value: 6A

| Operating temperature | ATEX Certificate | IECEX Certificate |
|-----------------------|----------------------|--------------------|
| - 50°C ÷ + 180°C | INERIS 14 ATEX 9016U | IECEX INE 14.0055U |

| ATEX & IECEX Equipment Data | | |
|-----------------------------|------------------|---------------------------------|
| Gas | Group I Zone 1 | Ex II 2G Ex db IIC or IIB+H2 Gb |
| Dust | Group II Zone 21 | Ex II 2D Ex tb IIIC Db IP66 |
| Mine | Group I | Ex I M2 Ex db I Mb |

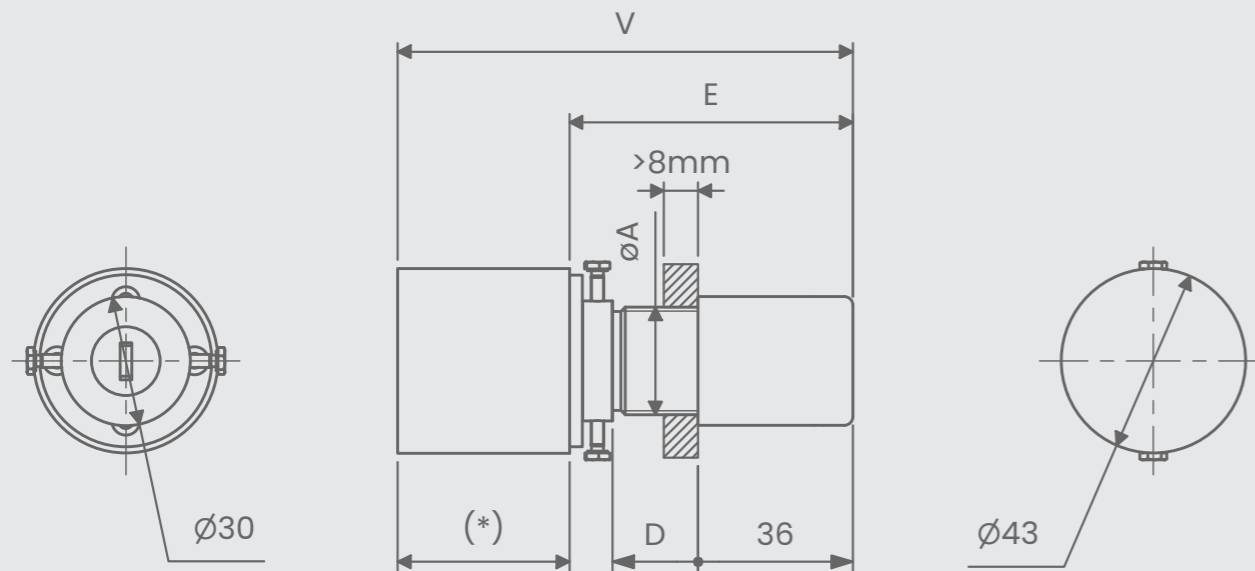

* Length changes according to the type of contact chosen

| Code | Ø A Threading | D | E | V | Wheight (g) |
|---------------|---------------|------|----|------------|-------------|
| RX20Y5 | M20x1.5 - 6g | 14.5 | 51 | 79.5 ÷ 104 | 210 |
| RX25Y5 | M25x1.5 - 6g | 14.5 | 51 | 79.5 ÷ 104 | 276 |
| RS20Y5 | M20x1.5 - 6g | 29.5 | 66 | 94.5 ÷ 119 | 230 |
| RS25Y5 | M25x1.5 - 6g | 29.5 | 66 | 94.5 ÷ 119 | 230 |

CAM OPERATED SWITCH

| RS SERIES | RX SERIES |
|---|--|
| Suitable for Ex d electrical enclosure IIB+H2 Internal Volume < 160,6 dm ³ IIC Internal Volume < 62,9 dm ³ | Suitable for Ex d electrical enclosure IIB+H2 Internal Volume < 2 dm ³ IIC Internal Volume < 2 dm ³ |

| ORDER CODING | | | |
|--------------|--------------------|--------------|--------------------|
| Code | Quadrant dimension | Key position | Electrical contact |
| RX20Y5 | A - 3103 | | K1002 |
| RX25Y5 | B - 3108 | | K1003 |
| RS20Y5 | C - 3311 | | K2003 |
| RS25Y5 | | | K2023 |
| | | | K3004 |

Example: RX25Y5Cbf-K1002

Indicate the position where the key cannot be removed.

- Body and ring in stainless steel AISI 316L
- Operating temperature: -60°C ÷ +180°C

INOX VERSION



| ORDER CODING | | | |
|--------------|--------------------|--------------|--------------------|
| Code | Quadrant dimension | Key position | Electrical contact |
| RXI20Y5 | A - 3103 | | K1002 |
| RXI25Y5 | B - 3108 | | K1003 |
| RSI20Y5 | C - 3311 | | K2003 |
| RSI25Y5 | | | K2023 |
| | | | K3004 |

Example: RXI25Y5Cbf-K1002

Indicate the position where the key cannot be removed.